

# Vacuum Pad EZP series.

## Pad shape/pad size :



平形/Flat ( U )



平形带肋/Flat with rib ( C )



风琴形/Bellows ( B )

吸盘直径/Pad diameter	2	4	6	8	10	13	16	20	25	32
平形/Flat ( U )										
平形带肋/Flat with rib ( C )										
风琴形/Bellows ( B )										

( 一可供选购 )

吸盘材料: 丁腈橡胶 ( 黑色 ), 硅橡胶 ( 白色 )  
Pad material: NBR (Black), Silicone rubber (White)  
( N ) ( S )

水平提升/Horizontal lifting      垂直提升/Vertical lifting

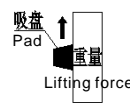
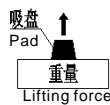

Noted ) Theoretical lifting force=Lifting force X safty factor  
Safty factor: horizontal lifting=4    Vertical lifting=8

## Theoretical lifting force data

吸盘直径/Pad area ( mm )	2	4	6	8	10	13	16	20	25	32
吸盘面积/Pad diameter ( cm <sup>2</sup> )	0.03	0.13	0.28	0.50	0.79	1.33	2.01	3.14	4.91	8.04
真空压力 Vacuum pressure ( kPa )	-85	0.27	1.07	2.40	4.27	6.67	11.3	17.1	26.7	41.7
	-80	0.25	1.00	2.26	4.02	6.28	10.6	16.1	25.1	39.3
	-75	0.24	0.94	2.12	3.77	5.89	10.0	15.1	23.6	36.8
	-70	0.22	0.88	1.98	3.52	5.50	9.3	14.1	22.0	34.3
	-65	0.20	0.82	1.84	3.27	5.10	8.6	13.1	20.4	31.9
	-60	0.19	0.75	1.70	3.01	4.71	8.0	12.1	18.8	29.4
	-55	0.17	0.69	1.55	2.76	4.32	7.3	11.1	17.3	27.0
	-50	0.16	0.63	1.41	2.51	3.93	6.7	10.0	15.7	24.5
	-45	0.14	0.57	1.27	2.26	3.53	6.0	9.0	14.1	22.1
	-40	0.13	0.50	1.13	2.01	3.14	5.3	8.0	12.6	19.6

## Product Code System

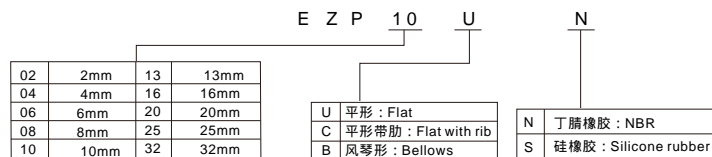

## Dimensions

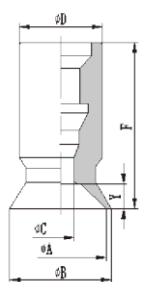

E Z P 02U ~ 08U

平行吸盘: Flat pad

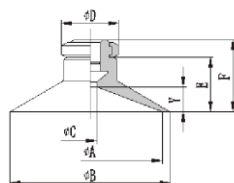

E Z P 10U ~ 32U

型号/Model	A	B	C	D	E	F	Y
E Z P 02U	2	2.6	1.2	7	-	12	0.5
E Z P 04U	4	4.8	1.6	7	-	12	0.8
E Z P 06U	6	7	2.5	7	-	12	0.8
E Z P 08U	8	9	2.5	7	-	12	1
E Z P 10U	10	12	4	13	7.7	12	3
E Z P 13U	13	15	4	13	7.7	12	3
E Z P 16U	16	16	4	13	8.2	12.5	3.5
E Z P 20U	20	23	4	15	9.5	14	4
E Z P 25U	25	28	4	15	9.5	14	4
E Z P 32U	32	35	4	15	10	14.5	4.5

## Dimensions

Flat with rib pad

EZP10C ~ 32C

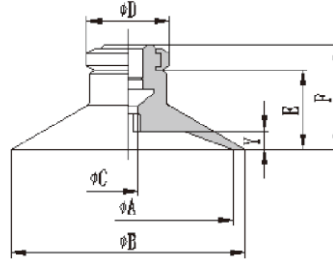

(mm)

型号/Model	A	B	C	D	E	F	Y
EZP10C	10	12	4	13	7.7	12	1.7
EZP13C	13	15	4	13	7.7	12	1.8
EZP16C	16	18	4	13	8.2	12.5	1.2
EZP20C	20	23	4	15	9.5	14	1.7
EZP25C	25	28	4	15	9.5	14	1.8
EZP32C	31	35	4	15	10	14.5	2.3

Bellows pad

EZP06B ~ 08B

EZP10B ~ 32B

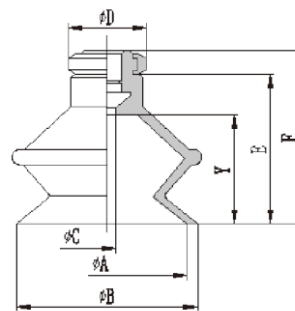
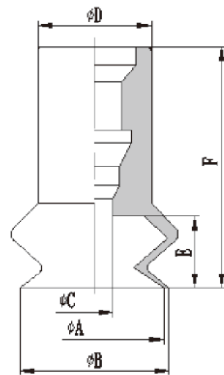

(mm)

型号/Model	A	B	C	D	E	F	Y
EZP06B	6	7	2.5	7	-	13	1.8
EZP08B	8	9	2.5	7	-	13	2
EZP10B	10	12	4	13	11.7	16	7
EZP13B	13	15	4	13	14.2	18.5	9
EZP16B	16	18	4	13	15.7	20	9.5
EZP20B	20	23	4	15	19	23.5	13.5
EZP25B	25	28	4	15	19.5	24	14
EZP32B	32	35	4	15	24.5	29	19